

# **RUSSELL PUMP**

## **Model A730**

**End Suction, Close Coupled, Bronze Fitted,  
Centrifugal Pump**

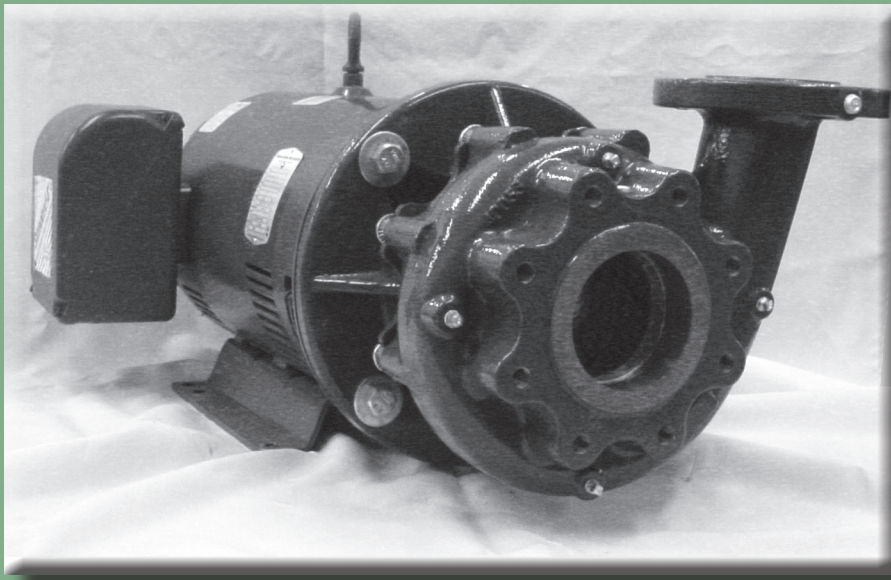

## **Typical Applications**

**General Purpose, OEM, Boosters,  
Cooling Towers, Boiler Feed,  
Process Fluids, HVAC, Irrigation,  
Hot and Chilled Water Circulation**

Russell Pump and Engineering Inc.  
102 W. Chicago Street  
Albion, IA 50005  
641-488-2319

# Design Features

## CASING

Constructed as ASTM A48 class 30 cast iron. The discharge can be mounted in any 90° position. Drain and air ports are also positioned every 90°, 1/4 npt suction and discharge tappings are standard. Back pull out design allows the pump to be serviced without disturbing the piping. The volute was designed to maximize hydraulic efficiency.

## MECHANICAL SEAL

Type 21 buna-n seal is rated to 225°F and pressure to 175PSI. Carbon seal face mates with the ceramic seat providing years of trouble free service. Alternate seals available upon request.

## IMPELLER

The hydraulic design of the impeller maximize pressure and gpm while minimizing horsepower. The enclosed impeller is made of cast bronze.

## ADAPTER

The precise machining of the adapter allows for easy assembly of the pump. A 1/8 npt hole is provided if a seal flush line is added. Construction consists of ASTM A48 class 30 cast iron.

## MOTOR

The NEMA JM frame motor utilizes a high carbon steel shaft. The motor's heavy duty ball bearings withstand axial and radial thrust loads with no problem. Standard Enclosure type is drain proof but alternates are available.

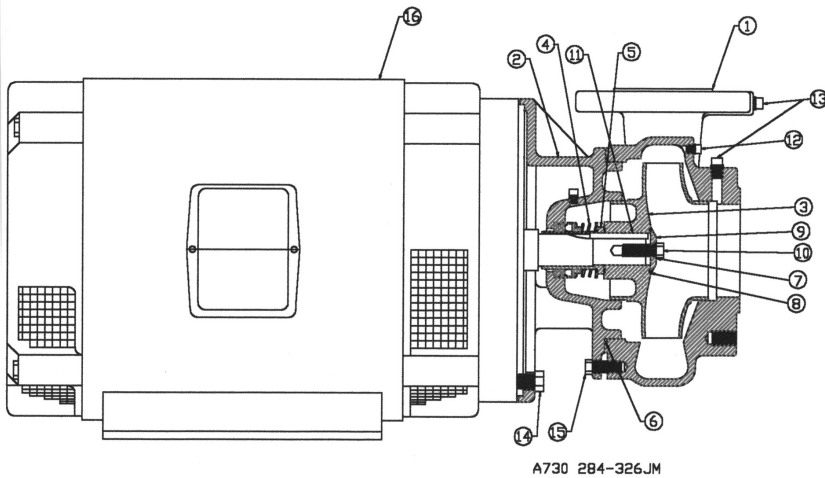

A730 284-326JM

1	CASING A730	CLASS 30 CAST IRON	40053	1
	ADAPTER A7 143-184JM	BRASS	40010	
	ADAPTER A7 213-215JM	CLASS 30 CAST IRON	40011	
	ADAPTER A7 254-326JM		40055	
2	ADAPTER A7 284-326JM		40056	1
	ADAPTER A7 143-184JM	BRASS	40012	
	ADAPTER A7 213-215JM		40013	
	ADAPTER A7 254-326JM			
	ADAPTER A7 284-326JM			
3	IMPELLER A730	SILICON BRONZE	40051	1
	IMPELLER A730	SILICON BRONZE	40052	
	MECHANICAL SEAL	BUNA-N	S-103	
4	143-215JM	VITON	S-104	1
	MECHANICAL SEAL	BUNA-N	S-105	
	254-326JM	VITON	S-106	
	MECHANICAL SEAL	BUNA-N	S-107	
5	143-215JM	VITON	S-108	
	SLEEVE 143-215JM	BRASS	10000	1
	SLEEVE 254-326JM	BRASS	10001	
6	O-RING CASING	BUNA-N	S-129	1
	O-RING CASING	VITON	S-130	
	O-RING WASHER	BUNA-N	S-131	
7	143-215JM	VITON	S-132	1
	O-RING WASHER	BUNA-N	S-133	
	254-326JM	VITON	S-134	
	O-RING IMPELLER	BUNA-N	S-135	
	143-215JM	VITON	S-136	
8	O-RING IMPELLER	BUNA-N	S-137	2
	254-326JM	VITON	S-138	
	IMPELLER WASHER	BUNA-N	S-139	
	143-215JM	VITON	S-140	
9	IMPELLER WASHER	BRASS	10002	1
	IMPELLER WASHER	BRASS	10003	
	IMPELLER CAP SCREW	3/8-16 X 1 BRASS	75020	
10	143-215JM	1/2-13 X 1 BRASS	75037	1
	IMPELLER CAP SCREW	3/8-16 X 1 BRASS	75021	
11	254-326JM	STAINLESS STEEL	10004	1
	KEY 143-215JM	STAINLESS STEEL	10005	
12	KEY 254-326JM	STAINLESS STEEL	10006	1
	PIPE PLUG	1/8 NPT BRASS	62825	2
13	PIPE PLUG	1/4 NPT BRASS	62826	2
	CAP SCREW 143-184JM	3/8-16 X 1 STEEL	19991	
14	CAP SCREW 213-215JM	1/2-13 X 1 STEEL	19957	4
	CAP SCREW 254-326JM	3/8-11 X 1 STEEL	19958	
15	CAP SCREW	1/2-13 X 1/4 STEEL	19958	4
16	MOTOR	-	-	1

# LIMITATIONS

MAXIMUM WORKING PRESSURE	-	175PSI
MAXIMUM GALLONS PER MINUTE	-	800
MAXIMUM HEAD PRODUCED	-	230FT.
RPM	-	3500 & 1750
MAXIMUM SEAL TEMP BUNA-N	-	225°
EPT	-	300°
VITON	-	400°
MAXIMUM HORSEPOWER	-	40

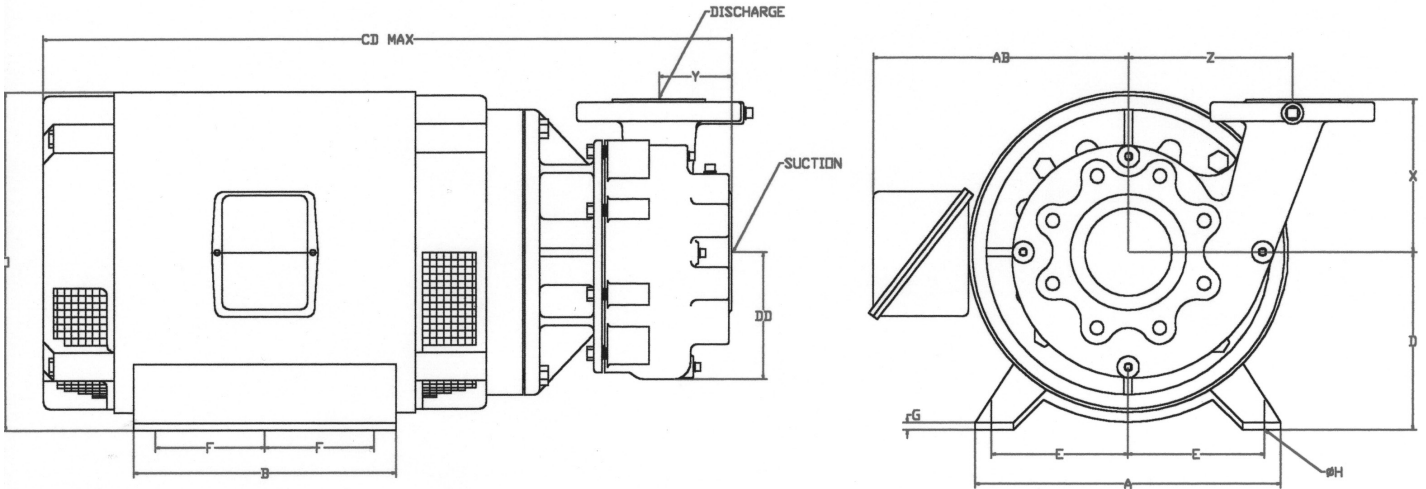

FRAME SIZE	SUCTION	DISCHARGE	A	AB	B	CP	D	DD	E	F	G	H	Ø	X	Y	Z	
143JM	4 FLANGE	3 FLANGE	7	5 1/4	5 15/16	16 31/32	3 1/2	5 3/4	2 3/4	2	1/8	11/32	6 7/8	6 61/64	3 7/16	7 1/32	
145JM					17 15/32	2 1/2											
182JM			9	5 7/8	6 1/2	19 15/32	4 1/2		3 3/4	3 3/4	2 1/4	3/16	13/32				8 7/16
184JM						20 1/32					2 3/4						
213JM			10 1/2	7 3/8	8	22 1/16	5 1/4		4 1/4	4 1/4	2 3/4	1/4	13/32				10 1/16
215JM						23 9/16					3 1/2						
254JM			11 1/4	8 15/16	9 1/2	26 31/64	6 1/4		5	5	4 1/8	1/2	17/32				12
256JM						11 3/4					28 15/64						
284JM			12 1/4	12 1/4	10 3/4	28 3/8	7		5 1/2	5 1/2	4 3/4	1/2	17/32				13 5/8
286JM						12 1/4					29 7/8						
324JM			13 3/16	13 3/16	12	33 3/16	8		6 1/4	6 1/4	5 1/4	3/4	21/32				15 9/16
326JM						13 1/2					34 3/16						

FRAME SIZE	HORSEPOWER - ODP				HORSEPOWER - TEFC	
	3500RPM 3Ø	3500RPM 1Ø	1750RPM 3Ø	1750RPM 1Ø	3500RPM 3Ø	1750RPM 3Ø
143JM	1, 1 1/2	1 1/2	1	1	1 1/2	1
145JM	2, 3	2	1 1/2, 2	1 1/2	2, 3	1 1/2, 2
182JM	5	3	3	2	3	3
184JM	7 1/2	5	5	3	5	5
213JM	10	7 1/2	7 1/2	5	7 1/2	7 1/2
215JM	15	10	10	7 1/2, 10	10	10
254JM	20	-	15	-	15	15
256JM	25	-	20	-	20	20
284JM	30	-	-	-	-	-
286JM	40	-	-	-	-	-
324JM	50	-	-	-	-	-
326JM	60	-	-	-	-	-

