

SHARPE[®] VALVES

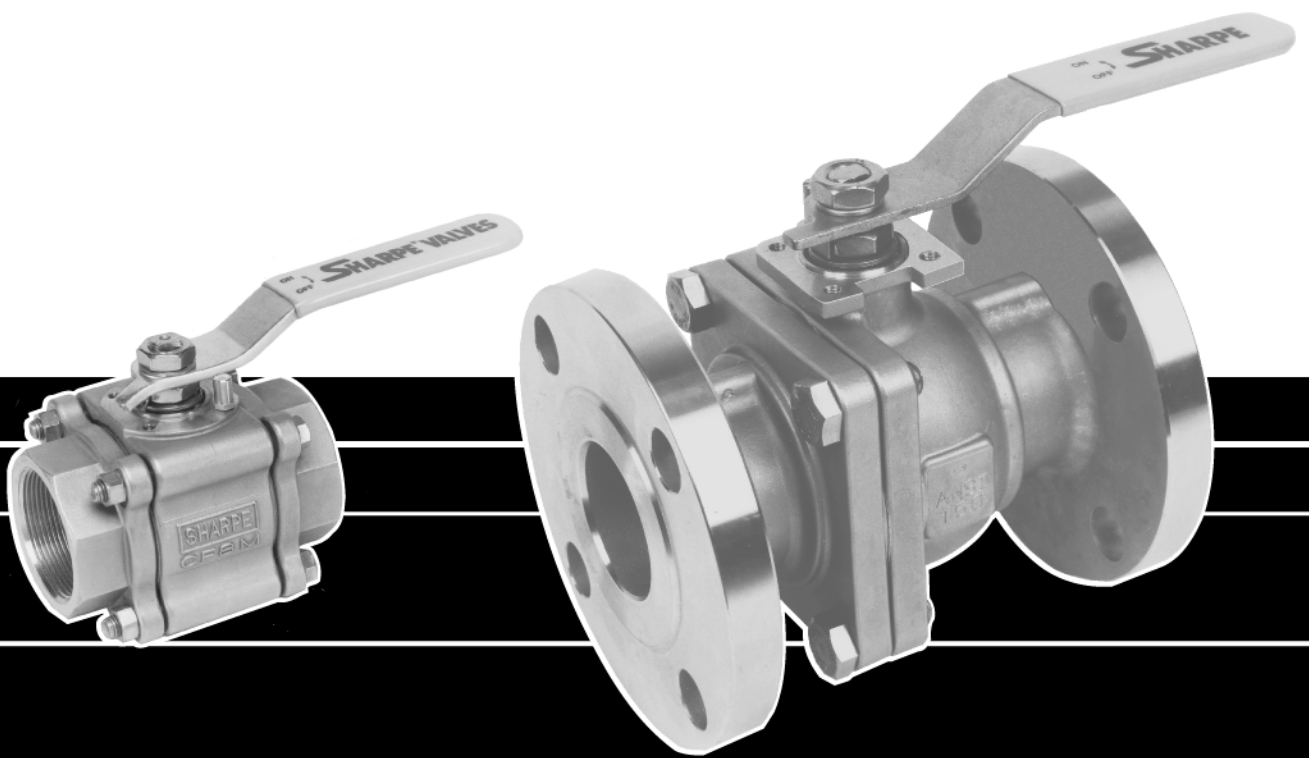

**SERIES W84/W99/W50
BALL VALVES
FOR STEAM SERVICES**

| Steam Service | Seat | Body Seal | Stem Seal |
|--------------------------|------------------------|--------------|-------------------|
| * Pressure up to 150 psi | R (Reinforced Teflon®) | Teflon® | Nova and PEEK |
| Pressure up to 450 psi | N (Nova) | G (Graphoil) | PEEK and Graphoil |
| Pressure up to 500 psi | P (PEEK) | G (Graphoil) | PEEK and Graphoil |

- Encapsulated Graphoil seals allow valve ends to be welded in line without disassembly saving costly labor time, and also prevent seal ruptures in high pressure or steam applications.
- Extended stem with lever or oval handles are designed to rise above pipe insulation.
- Gear operator for slow opening designed for applications where steam hammer is a concern.
- Pressure / Temperature ratings for flanged valves are limited to Class ratings.
- Steam service valves are fitted with red-sleeved handles.

- Live loaded stem packing provides long life between packing adjustments and compensates for thermal cycling.

TWO YEAR LIMITED WARRANTY

Sharpe® Valves warrants its Steam valves Series W against defects in manufacturing provided the products are used for the purposes for which they are manufactured and sold. Such warranty shall be binding on Sharpe® Valves for a period of two years from the date of shipment. The purchaser's right of remedy under this warranty shall be limited to the repair or replacement of products found to be defective by Sharpe® Valves.

Steam Ratings

| Valve Size | NOVA | | PEEK | |
|---|------------------------|---------------------------|------------------------|---------------------------|
| | Working Steam Pressure | Corresponding Temperature | Working Steam Pressure | Corresponding Temperature |
| W84-1/4", 3/8", 1/2" W99-1/4", 3/8" | 450 | 459°F | 500 | 470°F |
| W84 - 3/4" W99/50 - 1/2" | 425 | 455°F | 500 | 470°F |
| W84 - 1" W99/50 - 3/4" | 400 | 447°F | 500 | 470°F |
| W84 - 1-1/4" W99/50 - 1" | 350 | 435°F | 500 | 470°F |
| W84 - 1-1/2" W99/50 - 1-1/4" | 325 | 428°F | 500 | 470°F |
| W84 - 2" W99/50 - 1-1/2" | 300 | 424°F | 500 | 470°F |
| W84 - 2-1/2" - 4" W99 - 2"-3" W50 - 2"-4" | 250 | 406°F | 300 | 424°F |

* Consult Factory for larger sizes.

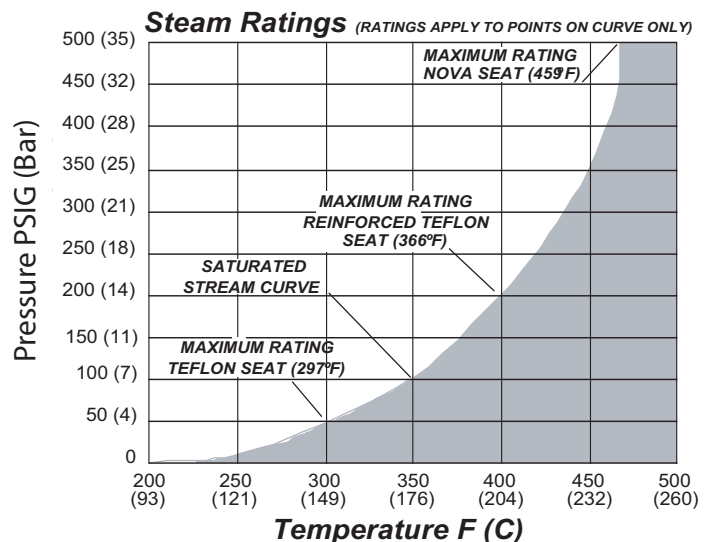

HOW TO ORDER 3PIECE - W84 STANDARD PORT - W99 FULL PORT

| VALVE SIZE | VALVE SERIES | BODY & ENDS | BALL & STEM | SEAT | SEAL | ENDS |
|-------------|--------------|---------------------|---------------------|-----------|--------------|-------------------------------------|
| 1/4" 1-1/2" | W84 | 4 = Carbon Steel | 6 = Stainless Steel | N = NOVA | G = Graphoil | TE = Threaded Ends (NPT) |
| 3/8" 2" | W99 | 6 = Stainless Steel | 2 = Alloy 20 | P = Peek® | | TEB = Threaded Ends (BSPT) |
| 1/2" 2-1/2" | | 2 = Alloy 20 | | | | BW = Butt Weld Sch. 5, 10, 40, & 80 |
| 3/4" 3" | | | | | | SW = Socket Weld |
| 1" 4"*** | | | | | | |

** W84 Only

HOW TO ORDER FLANGED VALVES W50

| VALVE SIZE | VALVE SERIES | CLASS | BODY | BALL & STEM | SEATS | SEALS |
|-----------------------------------|--------------|-----------|---------------------|---------------------|-----------|--------------|
| 1/2" 2" | W50 | 11 = 150# | 4 = Carbon Steel | 6 = Stainless Steel | N = NOVA | G = Graphoil |
| 3/4" 2-1/2" | | 33 = 300# | 6 = Stainless Steel | 2 = Alloy 20 | P = Peek® | |
| 1" 3" | | | 2 = Alloy 20 | | | |
| 1-1/2" 4" | | | | | | |
| Consult Factory for larger sizes. | | | | | | |

* Reinforced Teflon® Seat combined with Teflon® Seal are not part of Series W.

Rev. 1/08