

Electronic Pressure Switch



measuring
•
monitoring
•
analysing

PDD



PDD-15
PDD-25

PDD-55
PDD-75

- Measuring range: -30...0" Hg to 0...5800 psi or -1...0 bar to 0...400 bar
- Temperature: max. 176°F
- Accuracy: $\pm 0.5\%$ of full scale ($\pm 1.0\%$ of full scale for ranges ≤ 30 psi)
- Housing/fitting material: Stainless Steel
- Connection: $\frac{1}{4}$ NPT, $\frac{1}{2}$ NPT, G $\frac{1}{4}$, or G $\frac{1}{2}$



KOBOLD companies worldwide:

ARGENTINA, AUSTRIA, BELGIUM, BULGARIA, CANADA, CHILE, CHINA, COLUMBIA, CZECHIA, DOMINICAN REPUBLIC, EGYPT, FRANCE, GERMANY, GREAT BRITAIN, HUNGARY, INDIA, INDONESIA, ITALY, MALAYSIA, MEXICO, NETHERLANDS, PERU, POLAND, ROMANIA, SINGAPORE, SOUTH KOREA, SPAIN, SWITZERLAND, TAIWAN, THAILAND, TUNISIA, USA, VIETNAM

KOBOLD Instruments Inc.
1801 Parkway View Drive
Pittsburgh, PA 15205
USA Office:
412.788.2830
412.788.4890
info@koboldusa.com
www.koboldusa.com



Electronic pressure switch Model PDD

Description

KOBOLD pressure sensors/switches series PDD are cost effective electronic pressure switches with digital indication of actual pressure. One or two switch points, on /off-switch delay and hysteresis are within the programmable measuring range. A piezoresistive ceramic sensor is used. The units can be used where high switching accuracy is needed. Long term stability, repeatability and the compact and robust design makes them ideal for use in OEM applications.

Dimensions

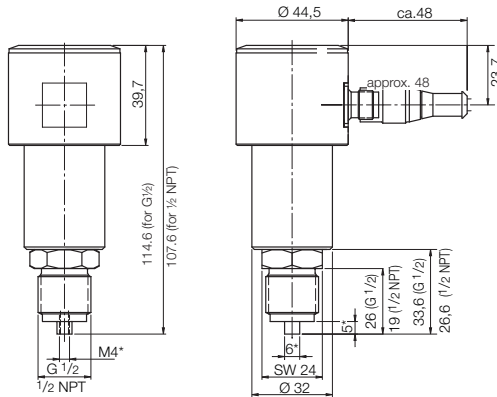

*No nipple on NPT thread
(dimensions 1/4" male on request)

Applications

- Compressor Monitoring
- Machinery Industry
- Installations
- Pumps

Order details (Example: PDD-15 3 N2 P065)

Model	Description	Output	Electrical Connection	Process Connection	Measuring Range [bar]	Measuring Range [psi]
PDD-	Electronic pressure switch made of stainless steel	15 = 1x PNP-switching output 25 = 1x NPN-switching output 55 = 2x PNP-switching output 75 = 2x NPN-switching output	3 = plug M12x1	N2 = 1/4 NPT N4 = 1/2 NPT R2 = G1/4 R4 = G 1/2	C315 = -1 - 0 B025 = 0 - 1 B035 = 0 - 1.6 B045 = 0 - 2.5 B055 = 0 - 4 B065 = 0 - 6 B075 = 0 - 10 B085 = 0 - 16 A095 = 0 - 25 A105 = 0 - 40 A115 = 0 - 60 A125 = 0 - 100 A135 = 0 - 160 A145 = 0 - 250 A155 = 0 - 400	H315 = -30 - 0 in Hg P025 = 0 - 15 P045 = 0 - 30 P055 = 0 - 50 P065 = 0 - 100 P075 = 0 - 150 P085 = 0 - 200 P095 = 0 - 350 P105 = 0 - 600 P115 = 0 - 1000 P125 = 0 - 1450 P135 = 0 - 3200 P145 = 0 - 3600 P155 = 0 - 5800 E = Custom*

Accessory: Mating Electrical Cable

Description	Item #
M12x1 socket with 6 foot cable	807.037
M12x1 socket with 16 foot cable	807.037/5M

*Please specify custom range as a note on your order

Technical Details

Housing:	303 stainless steel
Process Connection:	1/4" or 1/2" NPT 316 L stainless steel Option G 1/4 or G 1/2 male others on request
Gasket:	FKM (Option: EPDM)
Sensor element:	Piezoresistive ceramic cell
Indication:	3-digit LED, height 7 mm
Resolution:	Max. 0.2 psi (depending on measuring range and measured value)
Max. temperature:	Media: -4 ... +176°F Ambient: -4 ... +176°F
Max. over pressure:	Up to 870 psi: 3x 5800 psi: 1.5x the range
Supply voltage:	24 V _{DC} ±20 %
Power consumption:	approx. 100 mA (without switching output)
Electrical connection:	M12x1 plug
Switching output:	PNP or NPN semiconductor, max. 300 mA, short-circuit proof
Contact:	N/O or N/C, programmable
Switch point adjustment:	programmable via 2 buttons
Output indicator:	1 LED
Hysteresis:	adjustable via 2 buttons
ON/OFF-switching delay:	0.5 ... 99.5 s (separately adjustable)
Response time:	0.5 s
Accuracy:	±0.5 % of f. s. (±1.0 % of f. s. for measuring range: ≤ 30 psi)
Protection:	IP 65